

UNAUTHORIZED USE OF THIS
DRAWING IS STRICTLY PROHIBITED

| DAR | REV | DESCRIPTION | APPVD | DATE |
|------|-----|--------------------------------|-------|-------|
| 1323 | A | INITIAL RELEASE | TJD | 8-07 |
| 1497 | B | CHANGE LD HEIGHT & HEIGHT DIMS | DG | 11-08 |
| 3519 | C | SEE DAR | DG | 2-12 |

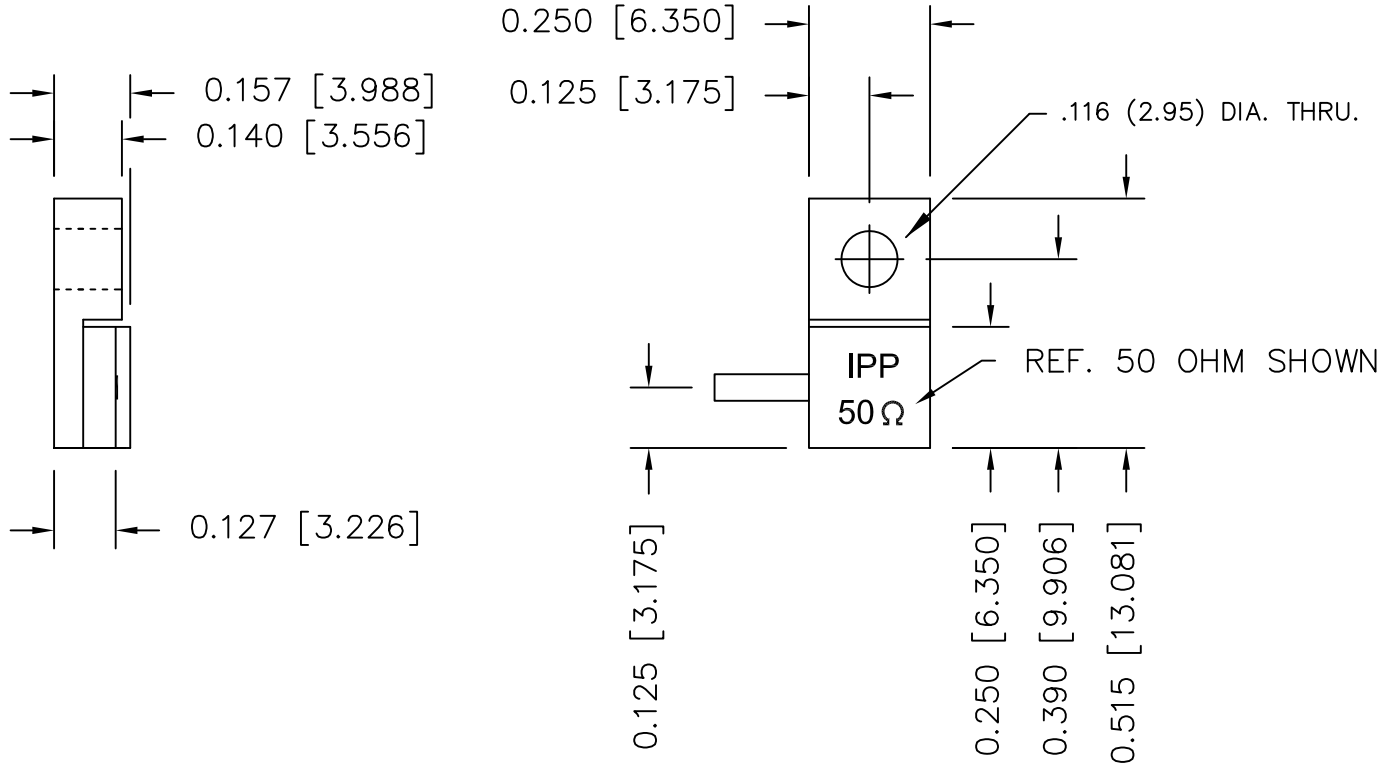

NOTES

- LEAD MATERIAL:
99.99% PURE SILVER,
.040 WIDE x .005 THICK
- LEAD LENGTH: .150 MIN.
- SUBSTRATE MATERIAL: BeO
COVER MATERIAL: Al₂O₃
- FLANGE MATERIAL: COPPER
PLATING: NICKEL

ELECTRICAL SPECIFICATIONS

INPUT POWER: 100 WATT
 FREQ: DC - 5.0 GHZ.
 VSWR: 1.10:1 DC - 4.2 GHZ.
 1.25:1 DC - 5 GHZ.

POWER DERATING CURVE

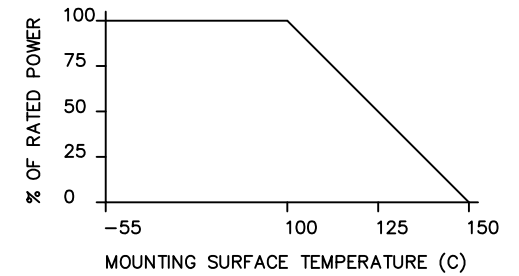

| PART NO. | VALUE | TOLERANCE |
|--------------|---------|-----------|
| IPP-TB221-50 | 50 OHMS | +/- 5% |

| | | | |
|--|------------------|--------------|--|
| MATERIAL [3] [4] | DWN DG | DATE 8-07 | |
| | ENG TJD | DATE 8-07 | |
| FINISH [4] | MANUF TP | DATE 8-07 | |
| TOLERANCE .XX ±.02 [.50] IN [MM] .XXX ±.010 [.254] | CAGE CODE: 437R2 | | TITLE TERMINATION, 100 WATT, FLANGE |
| | SHEET OF 1 1 | SCALE 4:1 | P/N IPP-TB221-XXX |
| | | | REV. C |