

UNAUTHORIZED USE OF THIS  
DRAWING IS STRICTLY PROHIBITED

| DAR  | REV | DESCRIPTION                       | APPVD | DATE  |
|------|-----|-----------------------------------|-------|-------|
| 1352 | A   | INITIAL RELEASE, UPDATED TOP VIEW | DG    | 11-07 |
| 1352 | B   | HOLE TO HOLE DIMENSION WAS 1.040  | DG    | 11-07 |
| 4490 | C   | SEE DAR                           | DG    | 8-13  |

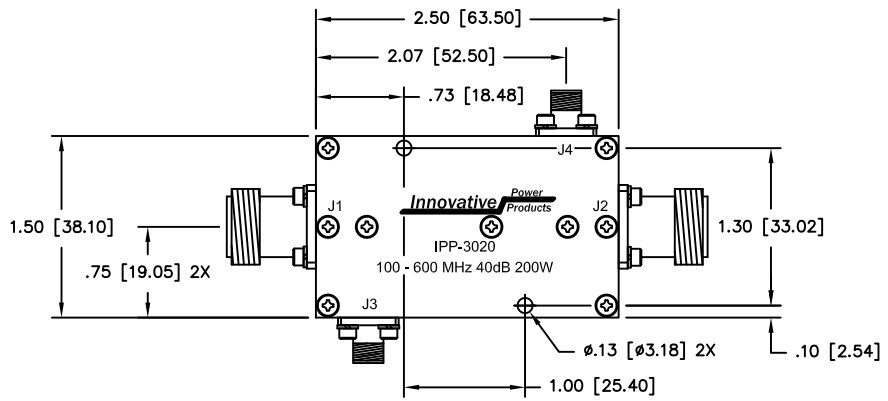

NOTES

- CONNECTOR TYPE J1 - J2: TYPE "N" FEMALE  
J3 - J4: TYPE SMA FEMALE

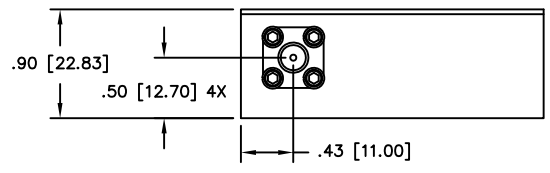

ELECTRICAL SPECIFICATIONS

- FREQUENCY: 100 - 600 MHz.  
 INSERTION LOSS: <0.30 dB  
 MAIN LINE VSWR: <1.25:1  
 COUPLING: 40.0dB ±1.0dB  
 DIRECTIVITY: >20dB  
 COUPLED FLATNESS: ±0.50dB  
 POWER: 200 WATT

|                                                                                      |                  |           |                                                                  |
|--------------------------------------------------------------------------------------|------------------|-----------|------------------------------------------------------------------|
| MATERIAL AL. ALLOY<br>6061-T651                                                      | DWN DG           | DATE 7-07 |                                                                  |
|                                                                                      | ENG TJD          | DATE 7-07 |                                                                  |
| FINISH CHEM FILM CLEAR<br>PER MIL-DTL-5541, TYPE 2, REV F,<br>CLASS 3 ROHS COMPLIANT | MANUF TP         | DATE 7-07 | TITLE DUAL DIRECTIONAL COUPLER<br>100 - 600 MHz. 200 WATT, 40 dB |
|                                                                                      | CAGE CODE: 437R2 |           | P/N IPP-3020                                                     |
| TOLERANCE .XX ±.02<br>.XXX ±.010<br>ANG. ±1/2°                                       | SHEET OF 1 1     | SCALE 1:1 |                                                                  |