

UNAUTHORIZED USE OF THIS  
DRAWING IS STRICTLY PROHIBITED

DAR	REV	DESCRIPTION	APPVD	DATE
5089	M	SEE DAR	DG	7-14
5098	N	SEE DAR	DG	7-14
5551	P	SEE DAR	TJD	4-15

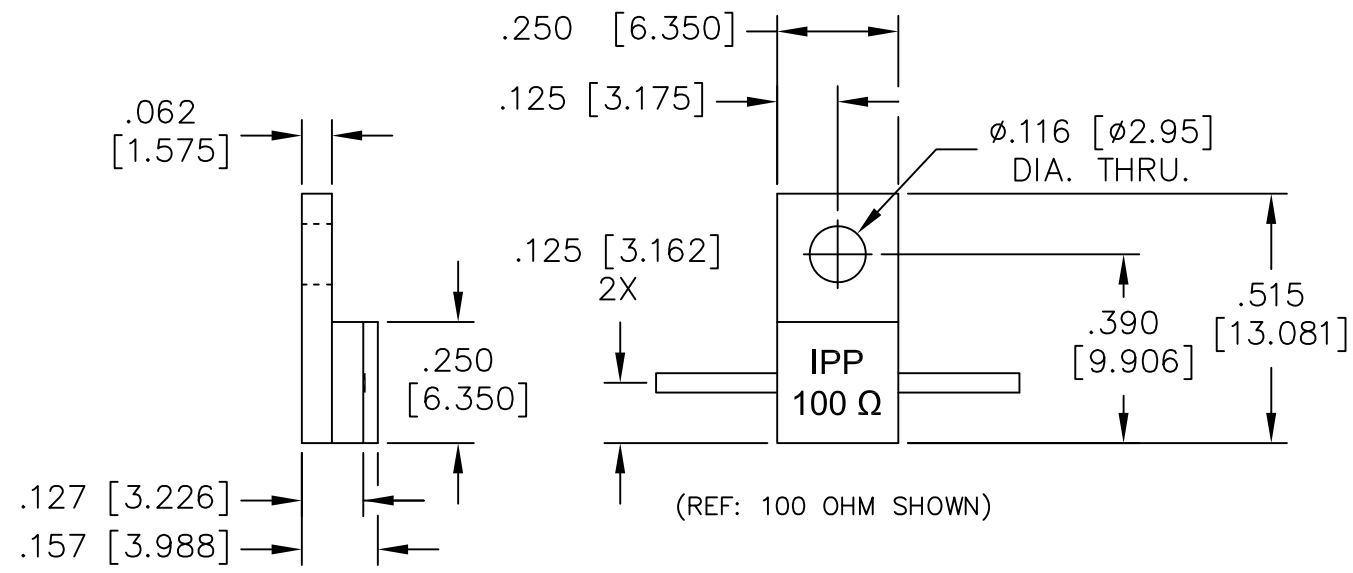

**NOTES:**

- LEAD MATERIAL: 99.99% PURE SILVER, .040 [1.016] WIDE x .005 [.127] THICK x .250 [6.350] MIN. LONG.
- SUBSTRATE MATERIAL: BeO  
COVER MATERIAL: Al<sub>2</sub>O<sub>3</sub>
- FLANGE MATERIAL: COPPER  
PLATING: NICKEL
- LEAD(S) WELDED TO SUBSTRATE.
- RoHS COMPLIANT.

ELECTRICAL SPECIFICATIONS

INPUT POWER: 50 WATT  
 FREQUENCY: DC - 4.2 GHZ.  
 CAPACITANCE: 1.2 pF

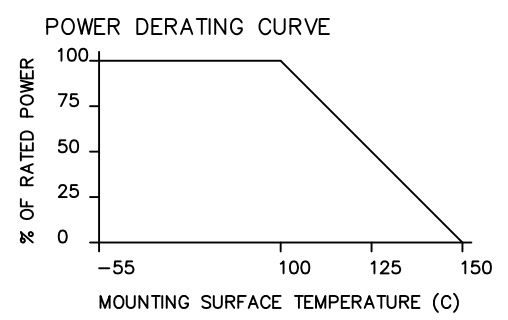

PART NO.	VALUE	TOLERANCE
IPP-RB203-0R5	0.5 OHMS	+/- 5%
IPP-RB203-10	10 OHMS	+/- 5%
IPP-RB203-16	16 OHMS	+/- 5%
IPP-RB203-25	25 OHMS	+/- 5%
IPP-RB203-50	50 OHMS	+/- 5%
IPP-RB203-75	75 OHMS	+/- 5%
IPP-RB203-100	100 OHMS	+/- 5%
IPP-RB203-150	150 OHMS	+/- 5%
IPP-RB203-200	200 OHMS	+/- 5%

PART NO.	VALUE	TOLERANCE
IPP-RB203-300	300 OHMS	+/- 5%
IPP-RB203-680	680 OHMS	+/- 5%
IPP-RB203-2700	2700 OHMS	+/- 5%

MATERIAL [2] [3]	DWN DG	DATE 5-06	
	ENG TJD	DATE 5-06	
FINISH [3]	MANUF TP	DATE 5-06	TITLE RESISTOR, 50 WATT, HALF FLANGE
	CAGE CODE: 437R2		P/N IPP-RB203-XXX
TOLERANCE IN [MM] .XX ±.02 [.50] .XXX ±.010 [.254]	SHEET OF 1 1	SCALE 4:1	REV. P