

UNAUTHORIZED USE OF THIS
DRAWING IS STRICTLY PROHIBITED

DAR	REV	DESCRIPTION	APPVD	DATE
2580	A	INITIAL RELEASE	DG	7-10
3596	B	SEE DAR	DG	4-12
5187	C	SEE DAR	DG	10-14

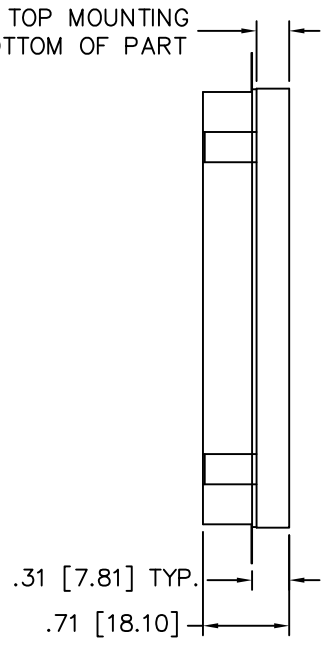
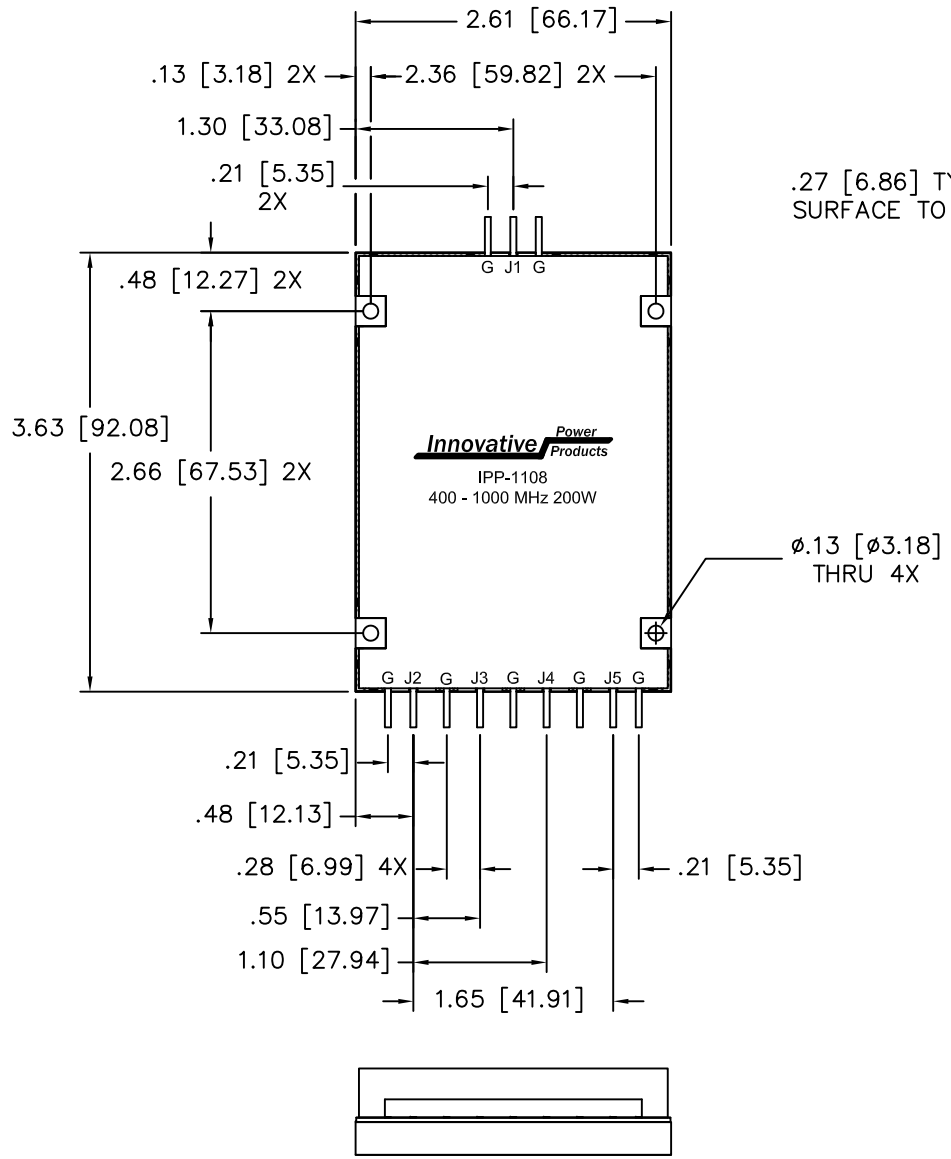

NOTES:

- LEADS: .050 [1.270] WIDE X .005 [.127] THK X .15 [3.81] LONG MIN.
- RoHS COMPLIANT.

ELECTRICAL SPECIFICATIONS

FREQUENCY:	400 - 1000 MHz.
INSERTION LOSS:	< 0.6 dB
VSWR:	< 1.30:1
PHASE BALANCE:	±5°
ISOLATION:	>10 dB
AMPLITUDE BALANCE:	<0.25dB
POWER:	200 WATT
TEMPERATURE:	-55°C TO 85°C

MATERIAL AL. ALLOY 6061-T651	DWN S.Cornell	DATE 4-30-10	Innovative Power Products		
	ENG DG	DATE 7-10			
FINISH CHEM FILM, CLEAR, PER MIL-DTL-5541, TYPE 2, REV. F, CLASS 3 (ROHS COMPLIANT)	MANUF	DATE	TITLE OUTLINE		
	CAGE CODE: 437R2		4 WAY COMBINER 400 - 1000 MHz 200 WATT		
TOLERANCE .XX ±.02 .XXX ±.010 ANG. ±1/2°	SHEET OF 1 1	SCALE 1:1	SIZE B	P/N IPP-1108	REV. C