

UNAUTHORIZED USE OF THIS  
DRAWING IS STRICTLY PROHIBITED

DAR	REV	DESCRIPTION	APPVD	DATE
3959	1	PRE-RELEASE	.	.

**PRELIMINARY**  
DIMENSIONS AND SPECIFICATIONS  
ARE SUBJECT TO CHANGE UNTIL  
INITIAL RELEASE OF DRAWING.

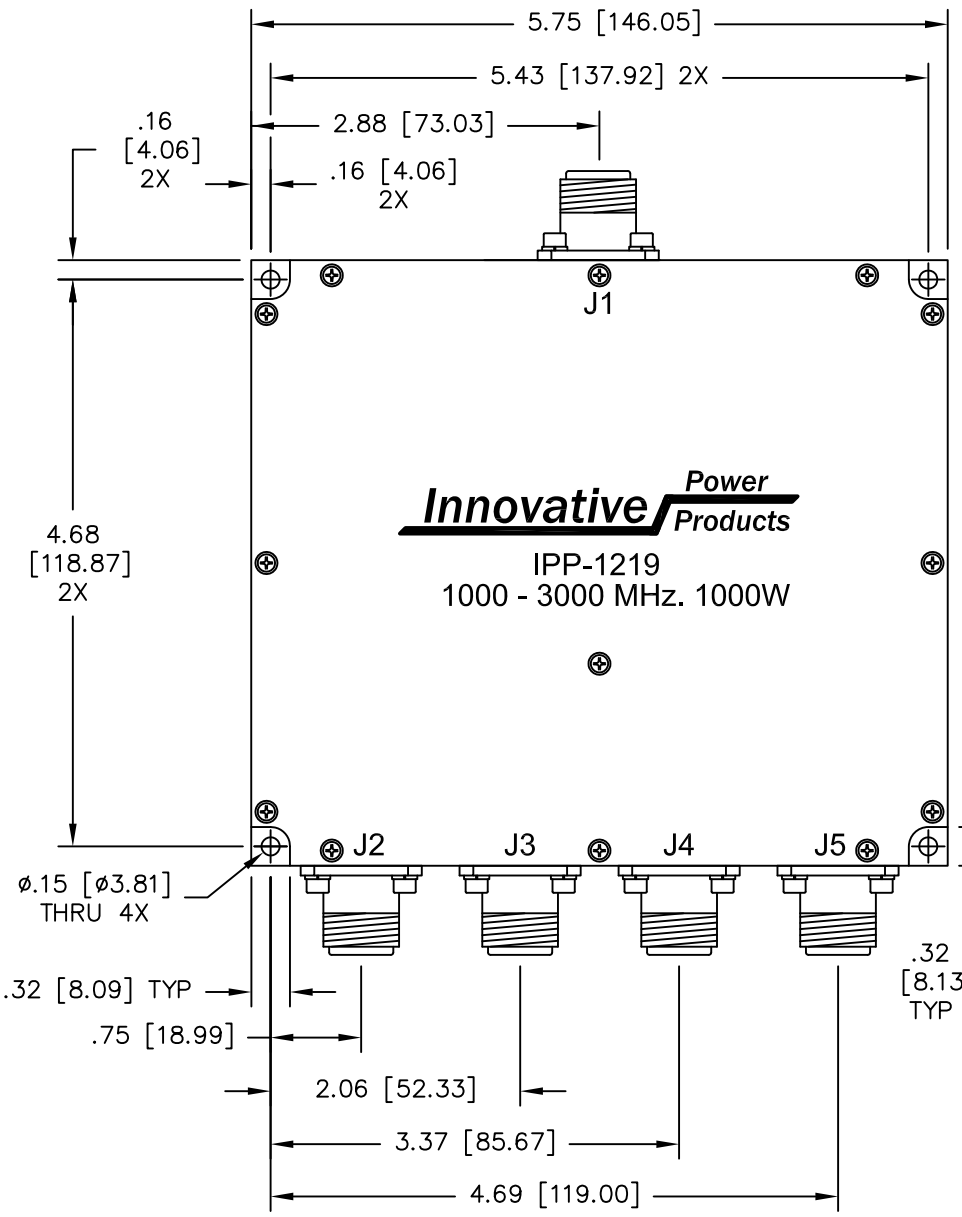

**Innovative Power Products**  
IPP-1219  
1000 - 3000 MHz. 1000W

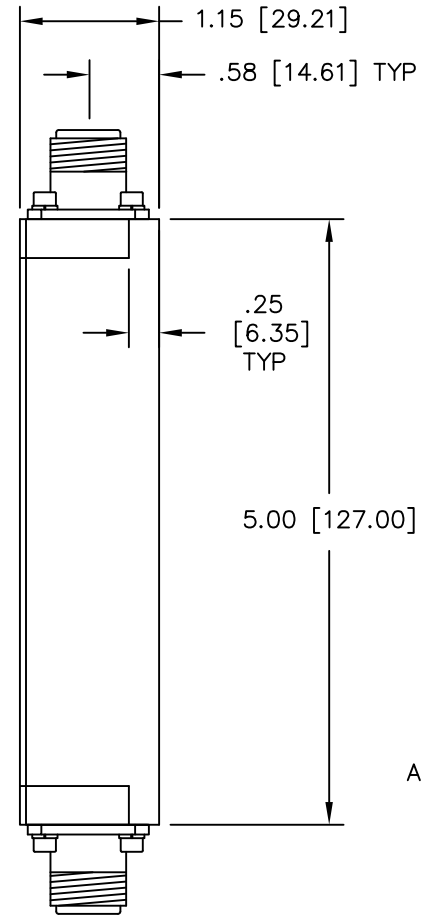

1. CONNECTORS: J1-5: TYPE "N" FEMALE.

ELECTRICAL SPECIFICATIONS

FREQUENCY: 1000 - 3000 MHz.  
 INSERTION LOSS: < 0.50 dB  
 VSWR: < 1.30:1  
 PHASE BALANCE: ±5°  
 POWER: 1000 WATT  
 ISOLATION: N/A  
 AMPLITUDE BALANCE: ±0.25 dB  
 TEMPERATURE: -55°C TO 85°C

MATERIAL AL. ALLOY 6061-T651	DWN S.Cornell	DATE 10-17-12	<b>Innovative Power Products</b>	
	ENG .	DATE .		
FINISH ELECTRODEPOSITED NICKEL PER QQ-N-290, .0003 MIN. SEMI-BRIGHT	MANUF	DATE	TITLE 4 - WAY 1000 - 3000 MHz 1000 WATT	
	CAGE CODE: 437R2		SIZE B	P/N IPP-1219
TOLERANCE .XX ±.02 .XXX ±.010 ANG. ±1/2°	SHEET OF 1 1	SCALE 1:1		