

UNAUTHORIZED USE OF THIS
DRAWING IS STRICTLY PROHIBITED

DAR	REV	DESCRIPTION	APPVD	DATE
1785	A	INITIAL RELEASE	DG	3-09
1940	B	SEE DAR	DG	6-09
4659	C	SEE DAR	DG	10-13

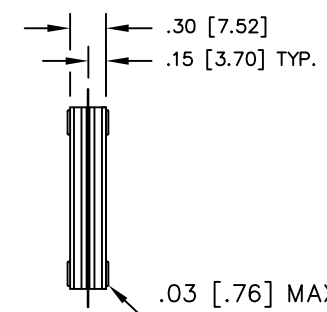
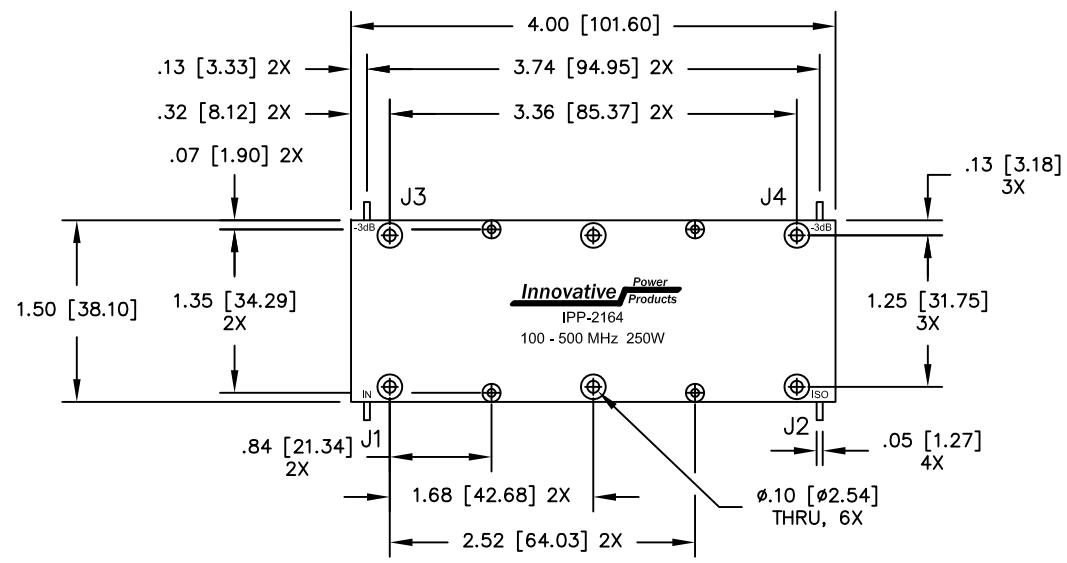

.03 [.76] MAX. EYELET PROJECTION
.22 [5.58] MAX. EYELET DIA.
(6X EACH SIDE, LARGE EYELETS)
.03 [.76] MAX. EYELET PROJECTION
.15 [3.94] MAX. EYELET DIA.
(4X EACH SIDE, SMALL EYELETS)

PORT CONFIGURATION				
INPUT	J1	J2	J3	J4
J1	---	ISOLATION	-3dB<0 DEG	-3dB<-90 DEG
J2	ISOLATION	---	-3dB<-90 DEG	-3dB<0 DEG
J3	-3dB<0 DEG	-3dB<-90 DEG	---	ISOLATION
J4	-3dB<-90 DEG	-3dB<0 DEG	ISOLATION	---

- NOTES:**
- LEAD MATERIAL: 99.99% PURE SILVER
.005 [.127] THICK X .15 [3.81] MIN.
LONG.
 - SEE 90° APPLICATION NOTE FOR
FURTHER INFORMATION.
 - RoHS COMPLIANT.
 - DATA AND SPECIFICATIONS APPLY
WHEN PART IS MOUNTED IN IPP TEST
FIXTURE TF-1091 TEST FIXTURE
CONFIGURATION/FOOTPRINT AVAILABLE
ON REQUEST.

ELECTRICAL SPECIFICATIONS

FREQUENCY: 100 - 500 MHz.
INSERTION LOSS: < 0.50 dB
VSWR: < 1.30:1
ISOLATION: > 16 dB
AMPLITUDE BALANCE: ±0.75 dB
PHASE BALANCE: ±5°
POWER: 250 WATT
TEMPERATURE: -55°C TO 85°C

MATERIAL AL. ALLOY, 6061-T6	DWN	DG	DATE	3-09	Innovative Power Products
	ENG	TJD	DATE	3-09	
FINISH CHEM FILM, CLEAR, PER MIL-DTL-5541, TYPE 2, REV. F, CLASS 3 (ROHS COMPLIANT)	MANUF	TP	DATE	3-09	TITLE OUTLINE, COUP., 90°, 100 - 500 MHz. 250W
	CAGE CODE: 437R2				
TOLERANCE .XX ±.02 [.50] .XXX ±.005 [.127] ANG. ±1/2°	SHEET	OF	SCALE	1:1	SIZE B
	1	1			P/N IPP-2164
					REV. C