

UNAUTHORIZED USE OF THIS  
DRAWING IS STRICTLY PROHIBITED

DAR	REV	DESCRIPTION	APPVD	DATE
4553	A	INITIAL RELEASE	DG	9-13

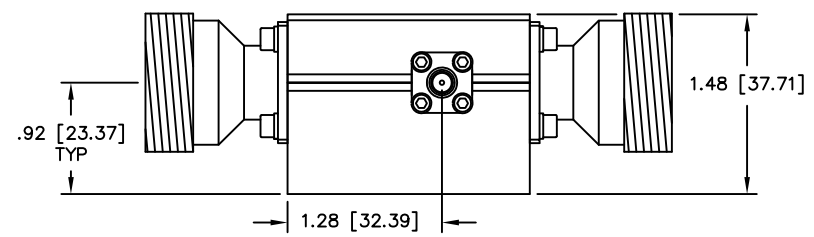
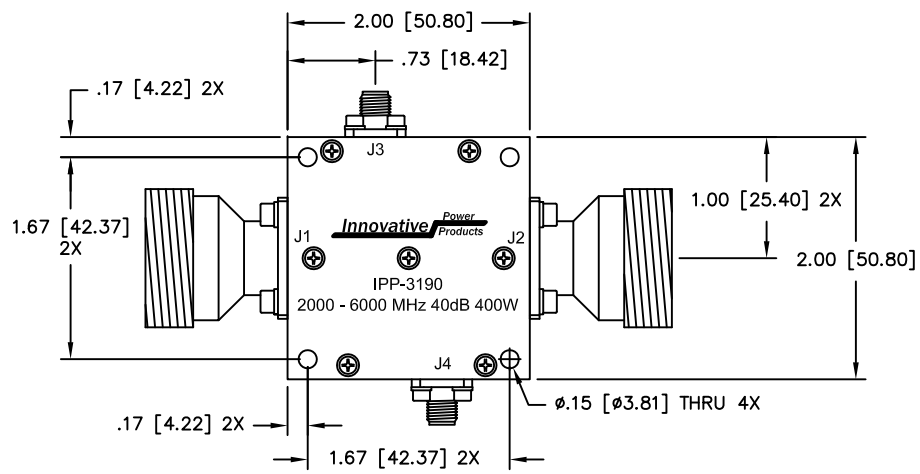

J1: INPUT  
J2: OUTPUT  
J3: -40dB (FWD COUPLED)  
J4: -40dB (REFL. COUPLED)

**NOTES:**

- J1 - J2: CONNECTOR TYPE "7-16" FEMALE  
J3 - J4: CONNECTOR TYPE "SMA" FEMALE
- RoHS COMPLIANT.

**ELECTRICAL SPECIFICATIONS**

FREQUENCY:	2000 - 6000 MHz.
INSERTION LOSS:	<0.35dB
MAIN LINE VSWR:	<1.30:1
COUPLING:	40.0 ±1.5dB
DIRECTIVITY:	> 17dB
COUPLED FLATNESS:	±0.75dB
POWER:	400 WATT
TEMPERATURE:	-55°C TO 85°C

MATERIAL AL. ALLOY 6061-T651	DWN S.Cornell	DATE 8-23-13			
	ENG DG	DATE 8-13			
FINISH CHEM FILM CLEAR PER MIL-DTL-5541, TYPE 2, REV F, CLASS 3, ROHS COMPLIANT	MANUF	DATE	TITLE DUAL DIRECTIONAL COUPLER 2000 - 6000 MHz. 400 WATT, 40 dB		
	CAGE CODE: 437R2				
TOLERANCE .XX ±.02 .XXX ±.010 ANG. ±1/2°	SHEET OF 1 1	SCALE 1:1	SIZE B	P/N IPP-3190	REV. A