

UNAUTHORIZED USE OF THIS
DRAWING IS STRICTLY PROHIBITED

DAR	REV	DESCRIPTION	APPVD	DATE
4263	A	INITIAL RELEASE	DG	4-13
4394	B	SEE DAR	DG	6-13
7125	C	SEE DAR	DG	4-18

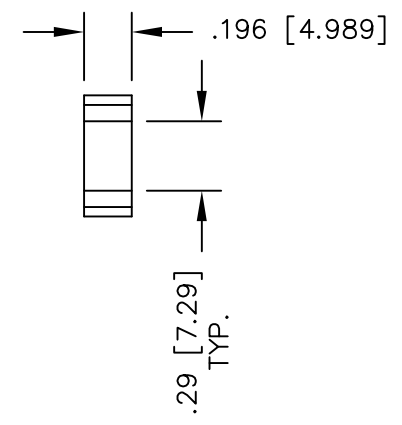
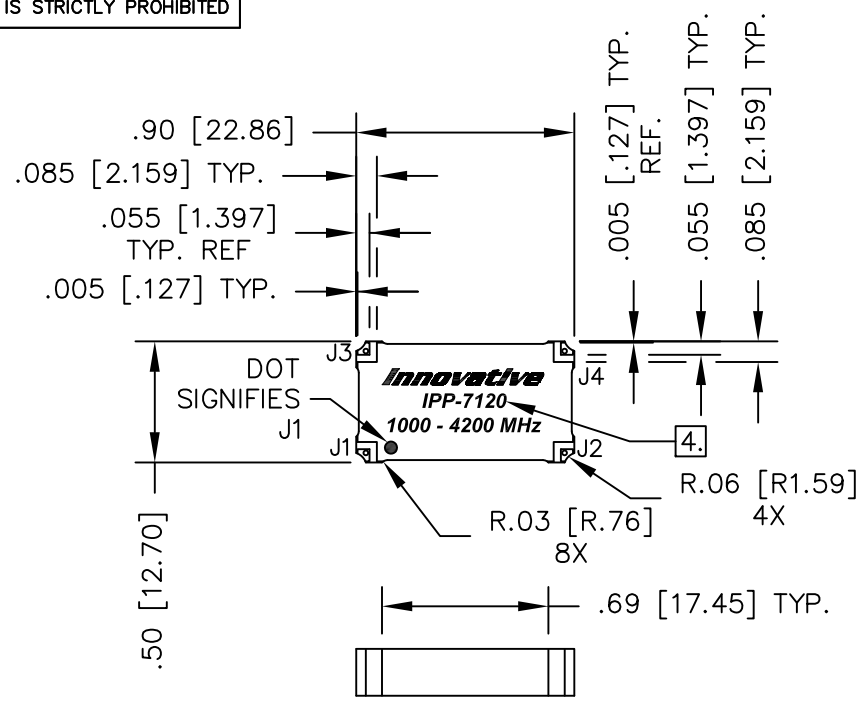

- NOTES:**
- SEE SMD COUPLER APPLICATION NOTE FOR FURTHER INFORMATION.
 - PARTS WITH RoHS MATTE TIN AND RoHS NICKEL GOLD FINISHES ARE RoHS COMPLIANT.
 - AVAILABLE IN TAPE AND REEL. SEE SMD COUPLER APPLICATION NOTE FOR FURTHER INFORMATION.
 - SEE CHART FOR PART NUMBER AND FINISH.

FINISH	
P/N	TYPE
IPP-7120	TIN/LEAD
IPP-7120RT	RoHS MATTE TIN
IPP-7120RG	RoHS NICKEL GOLD

ELECTRICAL SPECIFICATIONS

FREQUENCY: 1000 - 4200 MHz.
 INSERTION LOSS: <0.50 dB
 VSWR: <1.35:1
 ISOLATION: >16dB
 AMPLITUDE BALANCE: ±0.70dB
 PHASE BALANCE: ±5°
 POWER: 90 WATT
 TEMPERATURE: -55°C TO 85°C

PORT CONFIGURATION				
INPUT	J1	J2	J3	J4
J1	---	ISOLATION	-3dB<0 DEG	-3dB<-90 DEG
J2	ISOLATION	---	-3dB<-90 DEG	-3dB<0 DEG
J3	-3dB<0 DEG	-3dB<-90 DEG	---	ISOLATION
J4	-3dB<-90 DEG	-3dB<0 DEG	ISOLATION	---

MATERIAL	DWN S.Cornell	DATE 3-1-13			
	ENG DG	DATE 3-13			
FINISH SEE FINISH CHART	MANUF	DATE	TITLE OUTLINE		
	CAGE CODE: 437R2		SMD COUPLER, 90°, 1000 - 4200 MHz. 90W		
TOLERANCE	SHEET OF 1 1		SCALE 2:1	SIZE B	P/N IPP-7120*
IN [MM]	.XX ±.02 [.50] .XXX ±.010 [.254] ANG. ±1/2°				REV. C