

UNAUTHORIZED USE OF THIS
DRAWING IS STRICTLY PROHIBITED

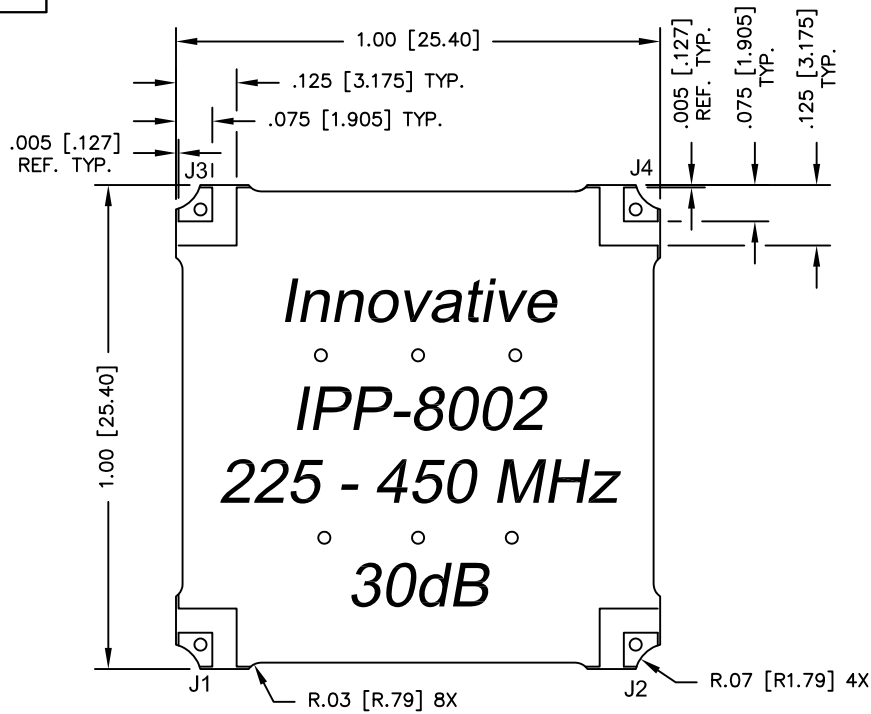

DAR	REV	DESCRIPTION	APPVD	DATE
2710	A	INITIAL RELEASE	TJD	9-10
2803	B	SEE DAR	TJD	11-10
4450	C	SEE DAR	DG	7-13

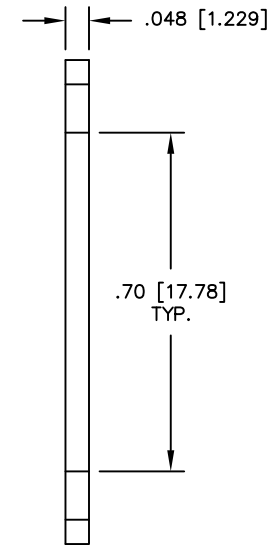

FINISH	
P/N	TYPE
IPP-8002	TIN/LEAD
IPP-8002RT	RoHS MATTE TIN
IPP-8002RG	RoHS NICKEL GOLD

NOTES:

- SEE SMD COUPLER APPLICATION NOTE FOR FURTHER INFORMATION.
- PARTS WITH RoHS MATT TIN AND RoHS NICKEL GOLD FINISHES ARE RoHS COMPLIANT.
- AVAILABLE IN TAPE AND REEL. SEE SMD COUPLER APPLICATION NOTE FOR FURTHER INFORMATION.

ELECTRICAL SPECIFICATIONS

FREQUENCY:	225 - 450 MHz.
INSERTION LOSS:	<0.25 dB
MAIN LINE VSWR:	<1.25:1
COUPLING:	30dB ±1.5 dB
DIRECTIVITY:	>16 dB
COUPLED FLATNESS:	±1.25 dB
POWER:	200 WATT
TEMPERATURE:	-55°C TO 85°C

PORT CONFIGURATION			
INPUT	OUTPUT	FORWARD COUPLED	REFLECTED COUPLED
J1	J2	J3	J4 ADD 50Ω TERMINATION
J1	J2	J3 ADD 50Ω TERMINATION	J4
J2	J1	J4	J3 ADD 50Ω TERMINATION
J2	J1	J4 ADD 50Ω TERMINATION	J3

MATERIAL	DWN DG	DATE 3-09		
FINISH	ENG TJD	DATE 3-09		
SEE FINISH CHART	MANUF TP	DATE 3-09	TITLE OUTLINE, SMD COUPLER	
TOLERANCE	CAGE CODE: 437R2		BI-DIRECTIONAL, 225 - 450 MHZ. 200W	
IN [MM]	SHEET 1	OF 1	SCALE 4:1	SIZE B
.XX ±.02 [.50]				P/N IPP-8002*
.XXX ±.010 [.254]				REV. C
ANG. ±1/2°				