

UNAUTHORIZED USE OF THIS
DRAWING IS STRICTLY PROHIBITED

DAR	REV	DESCRIPTION	APPVD	DATE
4844	H	SEE DAR	DG	3-14
5113	J	SEE DAR	DG	8-14
6646	K	SEE DAR	DG	4-17

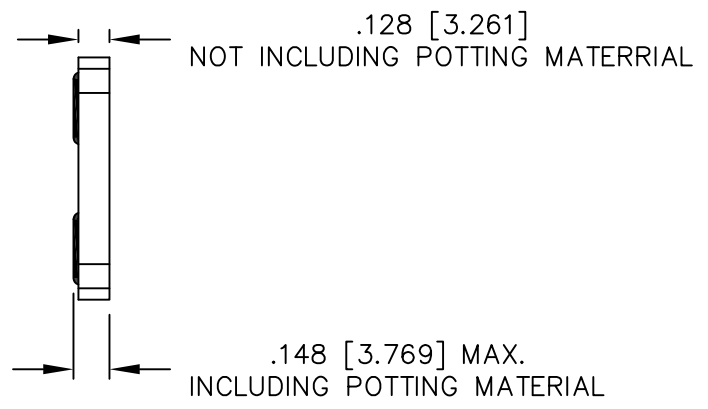
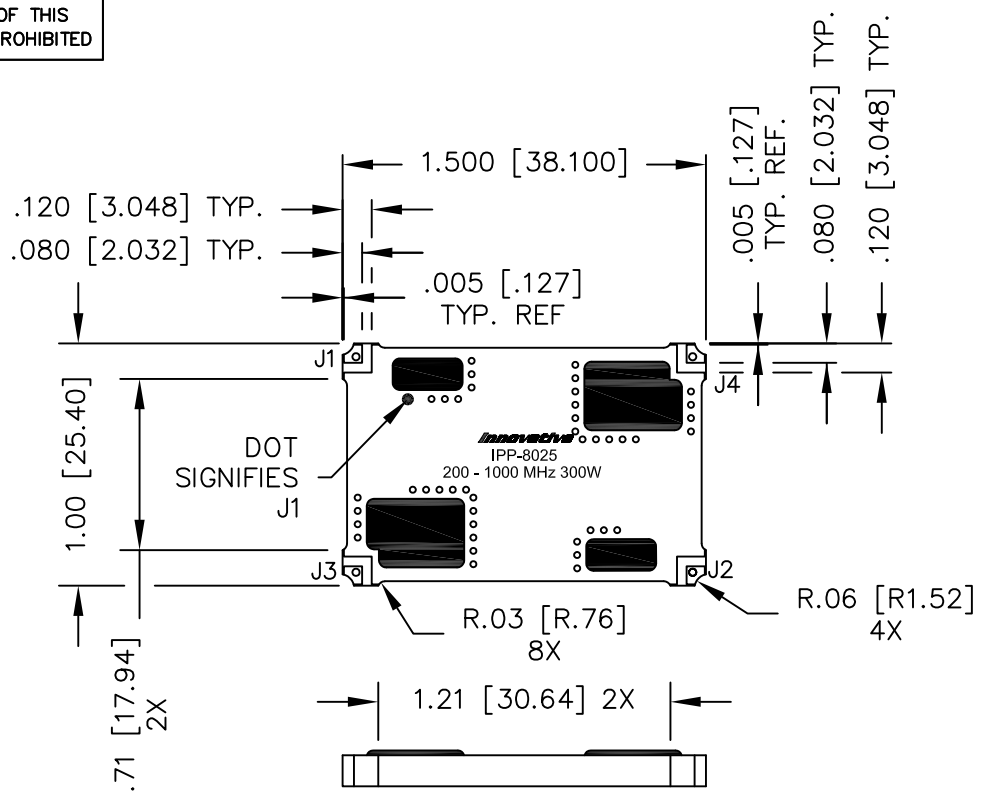

- NOTES:**
- SEE SMD COUPLER APPLICATION NOTE FOR FURTHER INFORMATION.
 - AVAILABLE IN TAPE AND REEL. SEE SMD COUPLER APPLICATION NOTE FOR FURTHER INFORMATION.
 - DO NOT EXCEED 220°C WHEN INSTALLING COUPLER.

ELECTRICAL SPECIFICATIONS

FREQUENCY: 200 – 1000 MHz.
 INSERTION LOSS: <0.35 dB
 MAIN LINE VSWR: <1.25:1
 DIRECTIVITY: >20dB
 COUPLING: 40.0±1dB
 COUPLED FLATNESS: ±0.6dB
 POWER: 300 WATT
 TEMPERATURE: -55°C TO 85°C

FINISH	
P/N	TYPE
IPP-8025	TIN/LEAD

PORT CONFIGURATION			
INPUT	OUTPUT	FORWARD COUPLED	REFLECTED COUPLED
J1	J2	J3	J4
J2	J1	J4	J3

MATERIAL	DWN DG	DATE 2-10				
FINISH SEE FINISH CHART	ENG TJD	DATE 2-10				
TOLERANCE	CAGE CODE: 437R2		TITLE OUTLINE SMD COUPLER, DDC, 200 - 1000 MHz. 300W			
IN [MM]	SHEET 1	OF 1	SCALE 2:1	SIZE B	P/N IPP-8025	REV. K