

UNAUTHORIZED USE OF THIS  
DRAWING IS STRICTLY PROHIBITED

DAR	REV	DESCRIPTION	APPVD	DATE
6443	N	SEE DAR	DG	10-16
6649	P	SEE DAR	DG	4-17
6887	Q	SEE DAR	DG	10-17

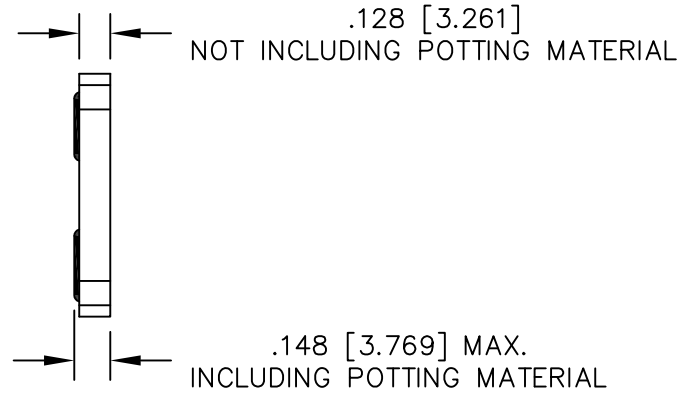
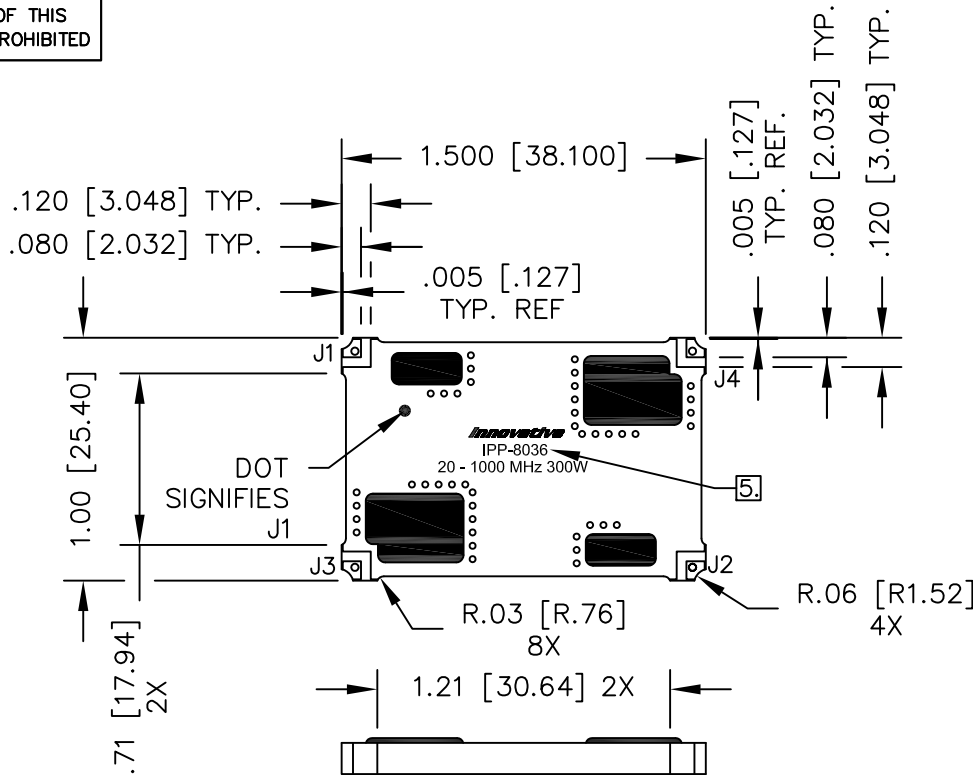

**NOTES:**

- SEE SMD COUPLER APPLICATION NOTE FOR FURTHER INFORMATION.
  - PARTS WITH RoHS TIN FINISH ARE RoHS COMPLIANT.
  - AVAILABLE IN TAPE AND REEL. SEE SMD COUPLER APPLICATION NOTE FOR FURTHER INFORMATION.
  - DO NOT EXCEED 220°C WHEN INSTALLING COUPLER.
- [5] SEE CHART FOR PART NUMBER AND FINISH.

**ELECTRICAL SPECIFICATIONS**

FREQUENCY: 20 - 1000 MHz.  
 INSERTION LOSS: <0.29 dB  
 MAIN LINE VSWR: <1.25:1  
 DIRECTIVITY: >20dB  
 COUPLING: 50.0±1.5dB  
 COUPLED FLATNESS: ±0.6dB  
 POWER: 300 WATT  
 TEMPERATURE: -55°C TO 85°C

FINISH	
P/N	TYPE
IPP-8036	TIN/LEAD
IPP-8036RT	RoHS MATTE TIN

PORT CONFIGURATION			
INPUT	OUTPUT	FORWARD COUPLED	REFLECTED COUPLED
J1	J2	J3	J4
J2	J1	J4	J3

MATERIAL	DWN S.Cornell	DATE 6-14-10	<b>Innovative Power Products</b>	
FINISH	ENG DG	DATE 6-10		
SEE FINISH CHART	MANUF	DATE	TITLE OUTLINE	
TOLERANCE	CAGE CODE: 437R2		SMD COUPLER, DDC, 20 - 1000 MHz. 300W	
.XX ±.02 [.50] .XXX ±.010 [.254] ANG. ±1/2°	SHEET 1	OF 2	SCALE 2:1	SIZE B
IN [MM]	P/N		IPP-8036*	REV. Q

UNAUTHORIZED USE OF THIS  
DRAWING IS STRICTLY PROHIBITED

DAR	REV	DESCRIPTION	APPVD	DATE
6443	N	SEE DAR	DG	10-16
6649	P	SEE DAR	DG	4-17
6887	Q	SEE DAR	DG	10-17

POCKET DETAIL

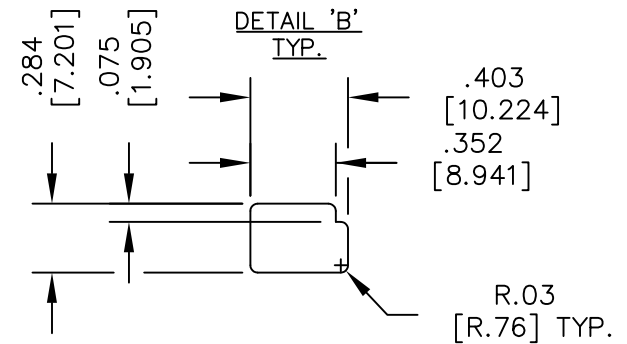
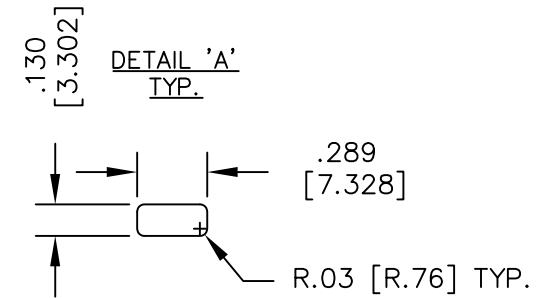
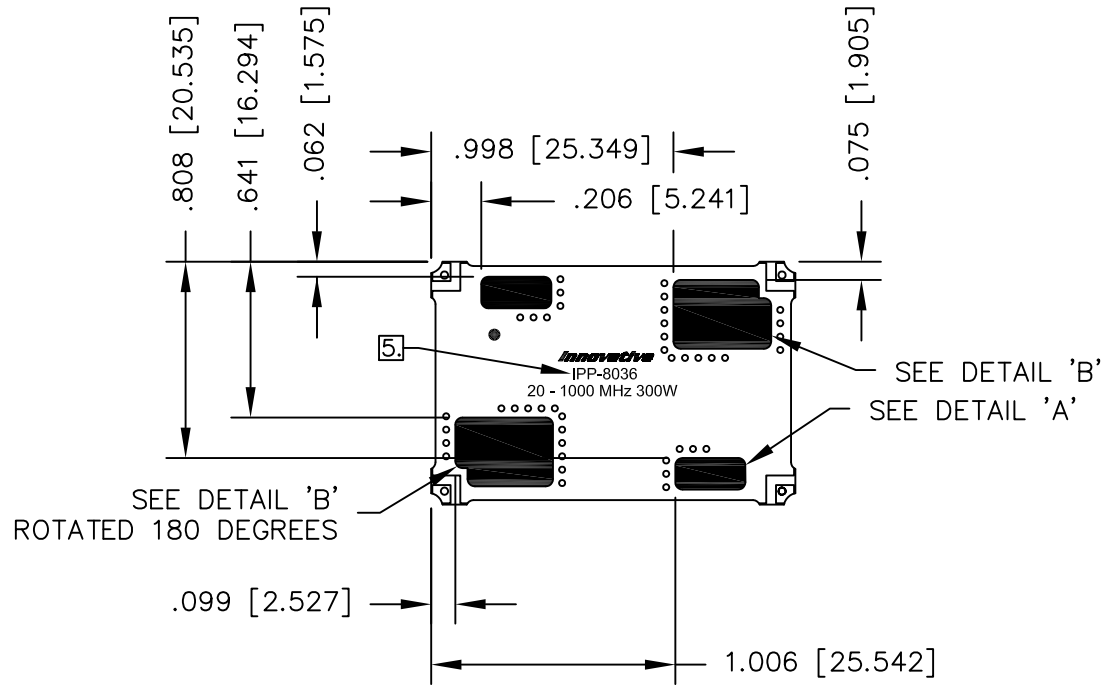

MATERIAL	DWN S.Cornell	DATE 6-14-10			
	ENG DG	DATE 6-10			
FINISH SEE FINISH CHART	MANUF	DATE	TITLE OUTLINE		
	CAGE CODE: 437R2		SMD COUPLER, DDC, 20 - 1000 MHz. 300W		
TOLERANCE IN [MM]	.XX ±.02 [.50]	SHEET OF 2 2	SCALE 2:1	SIZE	REV. Q
	.XXX ±.010 [.254] ANG. ±1/2°			P/N IPP-8036*	