

UNAUTHORIZED USE OF THIS
DRAWING IS STRICTLY PROHIBITED

DAR	REV	DESCRIPTION	APPVD	DATE
4448	E	SEE DAR	DG	7-13
4860	F	SEE DAR	DG	3-14
6646	G	SEE DAR	DG	4-17

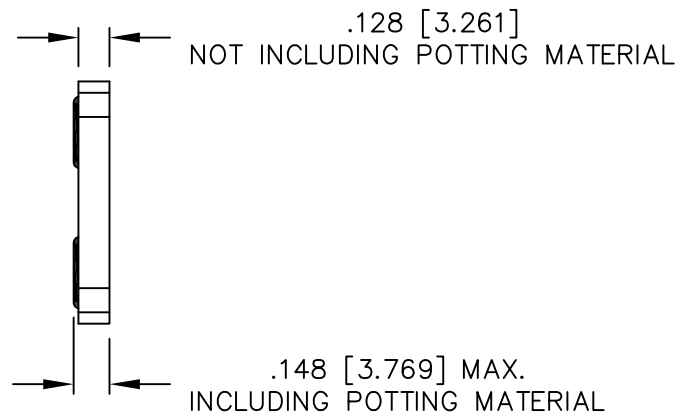
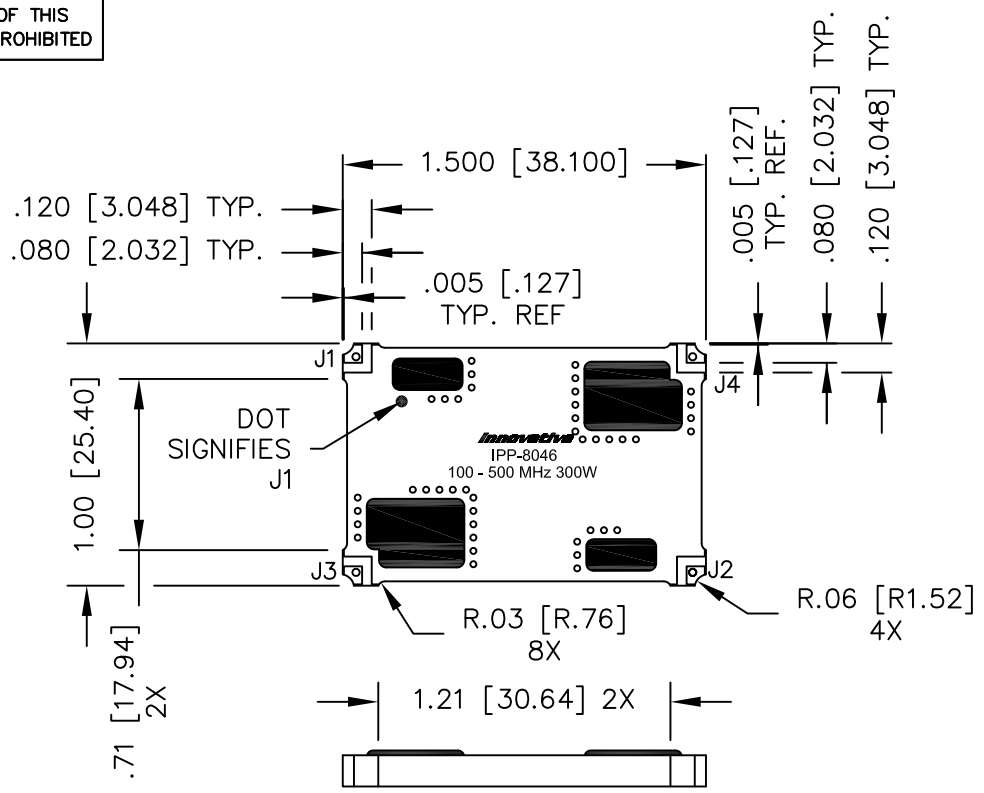

- NOTES:**
1. SEE SMD COUPLER APPLICATION NOTE FOR FURTHER INFORMATION.
 2. AVAILABLE IN TAPE AND REEL. SEE SMD COUPLER APPLICATION NOTE FOR FURTHER INFORMATION.
 3. DO NOT EXCEED 220°C WHEN INSTALLING COUPLER.

ELECTRICAL SPECIFICATIONS

FREQUENCY:	100 - 500 MHz.
INSERTION LOSS:	<0.25 dB
MAIN LINE VSWR:	<1.25:1
DIRECTIVITY:	>20dB
COUPLING:	40.0±1dB
COUPLED FLATNESS:	±0.6dB
POWER:	300 WATT
TEMPERATURE:	-55°C TO 85°C

FINISH	
P/N	TYPE
IPP-8046	TIN/LEAD

PORT CONFIGURATION			
INPUT	OUTPUT	FORWARD COUPLED	REFLECTED COUPLED
J1	J2	J3	J4
J2	J1	J4	J3

MATERIAL	DWN DG	DATE 12-10			
FINISH SEE FINISH CHART	ENG TJD	DATE 12-10			
TOLERANCE	CAGE CODE: 437R2		TITLE OUTLINE		
IN [MM]	SHEET 1	OF 1	SCALE 2:1	SMD COUPLER, DDC, 100 - 500 MHz. 300W	
.XX ±.02 [.50]			SIZE B	P/N IPP-8046	REV. G
.XXX ±.010 [.254]					
ANG. ±1/2°					