

UNAUTHORIZED USE OF THIS
DRAWING IS STRICTLY PROHIBITED

DAR	REV	DESCRIPTION	APPVD	DATE
4451	E	SEE DAR	DG	7-13
4860	F	SEE DAR	DG	3-14
6649	G	SEE DAR	DG	4-17

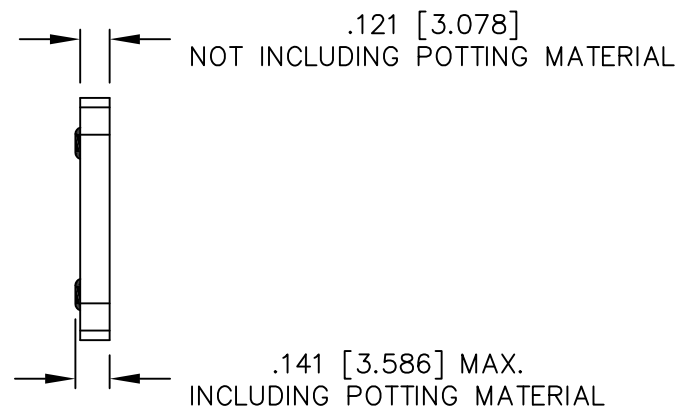
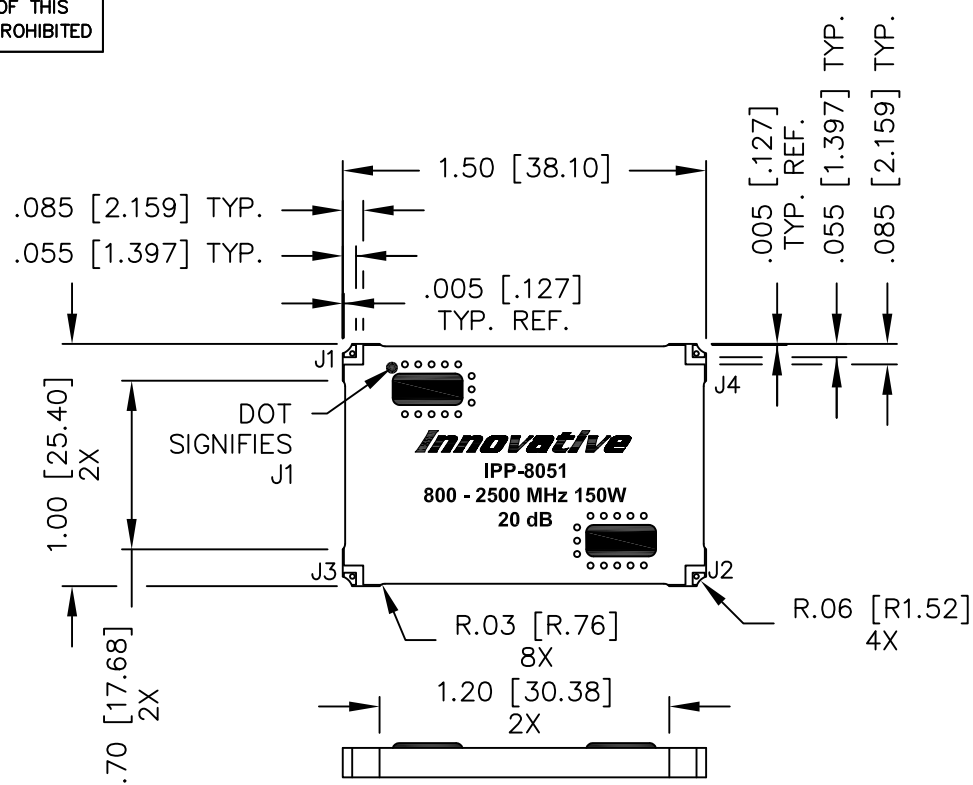

- NOTES:**
- SEE SMD COUPLER APPLICATION NOTE FOR FURTHER INFORMATION.
 - AVAILABLE IN TAPE AND REEL. SEE SMD COUPLER APPLICATION NOTE FOR FURTHER INFORMATION.
 - DO NOT EXCEED 220°C WHEN INSTALLING COUPLER.

ELECTRICAL SPECIFICATIONS

FREQUENCY:	800 – 2500 MHz.
INSERTION LOSS:	<0.40 dB
MAIN LINE VSWR:	<1.25:1
DIRECTIVITY:	>20dB
COUPLING:	20.0±1.5dB
COUPLED FLATNESS:	±0.85dB
POWER:	150 WATT
TEMPERATURE:	-55°C TO 85°C

FINISH	
P/N	TYPE
IPP-8051	TIN/LEAD

PORT CONFIGURATION			
INPUT	OUTPUT	FORWARD COUPLED	REFLECTED COUPLED
J1	J2	J3	J4
J2	J1	J4	J3

MATERIAL	DWN S.Cornell	DATE 8-2-11				
FINISH	ENG DG	DATE 8-11				
SEE FINISH CHART	MANUF	DATE	TITLE OUTLINE			
TOLERANCE	CAGE CODE: 437R2		SMD COUPLER, DDC, 800 - 2500 MHz. 150W			
IN [MM]	SHEET 1	OF 1	SCALE 2:1	SIZE B	P/N IPP-8051*	REV. G