

UNAUTHORIZED USE OF THIS
DRAWING IS STRICTLY PROHIBITED

DAR	REV	DESCRIPTION	APPVD	DATE
4708	C	SEE DAR	DG	12-13
6077	D	SEE DAR	TJD	3-16
6657	E	SEE DAR	DG	4-17

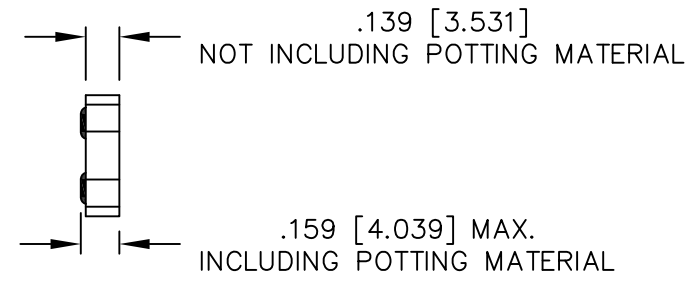
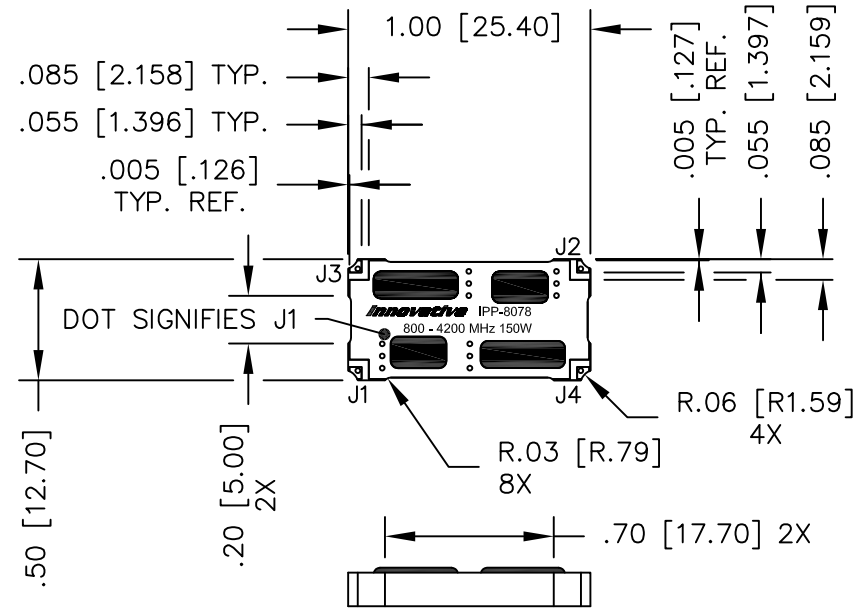

- NOTES:**
- SEE SMD COUPLER APPLICATION NOTE FOR FURTHER INFORMATION.
 - SHIELDING OF 50 OHM LAUNCH LINES MAY BE REQUIRED TO MAINTAIN ISOLATION BETWEEN PORTS.
 - AVAILABLE IN TAPE AND REEL. SEE SMD COUPLER APPLICATION NOTE FOR FURTHER INFORMATION.
 - DO NOT EXCEED 220°C WHEN INSTALLING COUPLER.

ELECTRICAL SPECIFICATIONS

FREQUENCY: 800 – 4200 MHz.
 INSERTION LOSS: <0.30 dB
 MAIN LINE VSWR: <1.30:1
 DIRECTIVITY: >18dB
 COUPLING: 32±1.5dB
 COUPLED FLATNESS: ±0.8dB
 POWER: 150 WATT
 TEMPERATURE: -55°C TO 85°C

PORT CONFIGURATION			
INPUT	OUTPUT	FORWARD COUPLED	REFLECTED COUPLED
J1	J2	J3	J4
J2	J1	J4	J3

MATERIAL	DWN S.Cornell	DATE 4-26-13	Innovative Power Products	
FINISH	ENG DG	DATE 4-13		
TIN/LEAD	MANUF	DATE	TITLE OUTLINE	
TOLERANCE	CAGE CODE: 437R2		SMD COUPLER, DDC, 800 - 4200 MHz. 150W	
IN [MM]	SHEET 1	OF 1	SCALE 2:1	SIZE B
.XX ±.02 [.50] .XXX ±.010 [.254] ANG. ±1/2°			P/N	IPP-8078*
				REV. E