

UNAUTHORIZED USE OF THIS  
DRAWING IS STRICTLY PROHIBITED

DAR	REV	DESCRIPTION	APPVD	DATE
5122	A	INITIAL RELEASE	DG	8-14
6662	B	SEE DAR	DG	4-17
7022	C	SEE DAR	DG	1-18

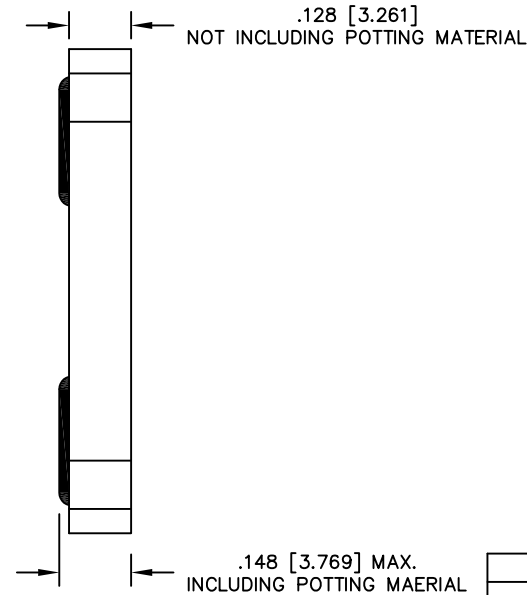
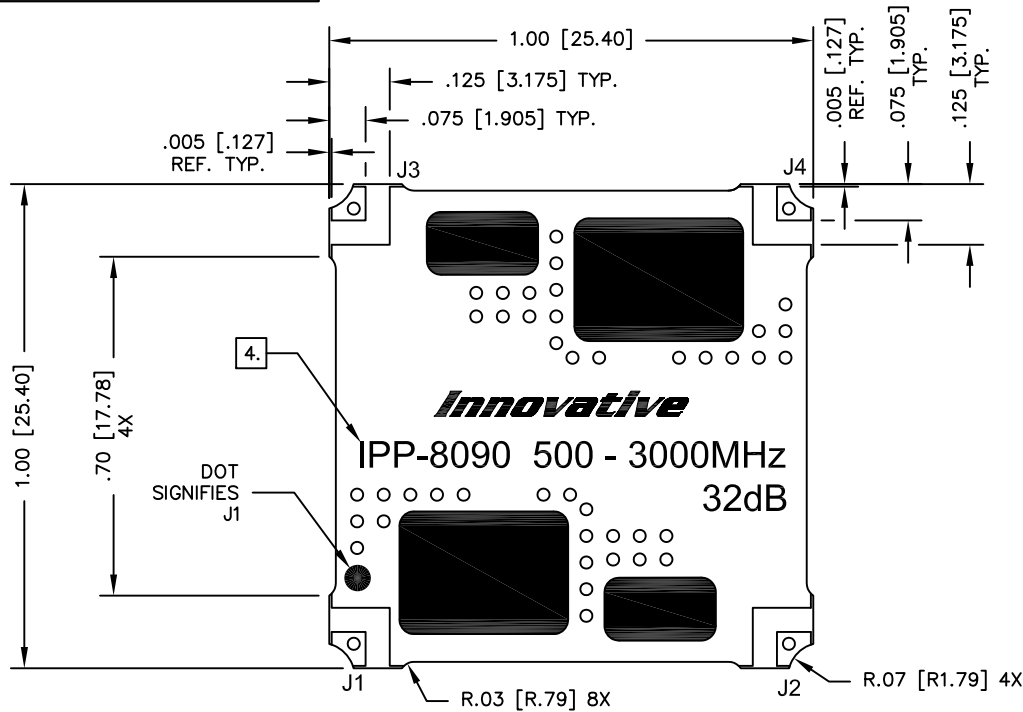

**NOTES:**

- SEE SMD COUPLER APPLICATION NOTE FOR FURTHER INFORMATION.
- AVAILABLE IN TAPE AND REEL. SEE SMD COUPLER APPLICATION NOTE FOR FURTHER INFORMATION.
- DO NOT EXCEED 220°C WHEN INSTALLING COUPLER.
- SEE CHART FOR PART NUMBER AND FINISH.

ELECTRICAL SPECIFICATIONS

FREQUENCY: 500 - 3000 MHz.  
 INSERTION LOSS: <0.30 dB  
 MAIN LINE VSWR: <1.30:1  
 COUPLING: 32dB ±1.5 dB  
 DIRECTIVITY: >17 dB  
 COUPLED FLATNESS: ±1.0dB  
 POWER: 200 WATT  
 TEMPERATURE: -55°C TO 85°C

FINISH	
P/N	TYPE
IPP-8090	TIN/LEAD
IPP-8090RT	RoHS MATTE TIN

PORT CONFIGURATION			
INPUT	OUTPUT	FORWARD COUPLED	REFLECTED COUPLED
J3	J2	J1	J4
J2	J3	J4	J1

MATERIAL	DWN S.Cornell	DATE 6-30-14	<b>Innovative</b> <i>Power</i> <b>Products</b>			
FINISH	ENG DG	DATE 6-14				
SEE FINISH CHART	MANUF	DATE	TITLE OUTLINE, SMD COUPLER			
TOLERANCE	CAGE CODE: 437R2		DUAL DIRECTIONAL, 500 - 3000 MHz. 200W			
IN [MM]	.XX ±.02 [.50] .XXX ±.010 [.254] ANG. ±1/2°	SHEET 1 OF 1	SCALE 4:1	SIZE B	P/N IPP-8090	REV. C