

UNAUTHORIZED USE OF THIS
DRAWING IS STRICTLY PROHIBITED

DAR	REV	DESCRIPTION	APPVD	DATE
5585	A	INITIAL RELEASE	DG	5-15
9892	B	SEE DAR	DG	11-24

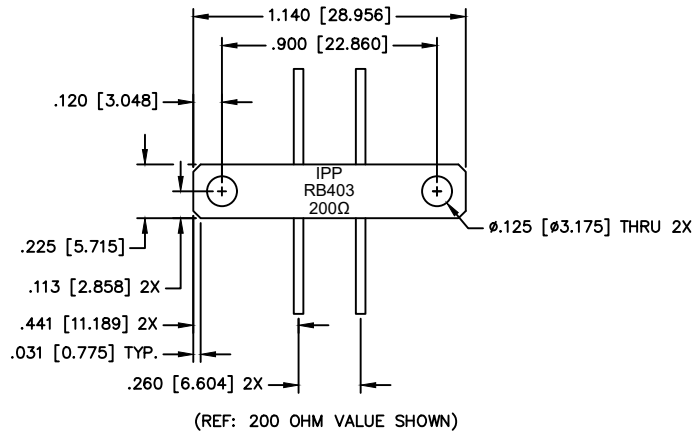

PRELIMINARY
DIMENSIONS AND SPECIFICATIONS
ARE SUBJECT TO CHANGE UNTIL
INITIAL RELEASE OF DRAWING.

NOTES:

1. LEAD MATERIAL: 99.99% PURE SILVER, .040 [1.016] WIDE x .005 [.127] THICK x .500 [12.700] MIN. LONG.
2. SUBSTRATE MATERIAL: BeO
3. FLANGE MATERIAL: ALUMINUM
4. PLATING: NICKEL
5. LEAD(S) WELDED TO SUBSTRATE.

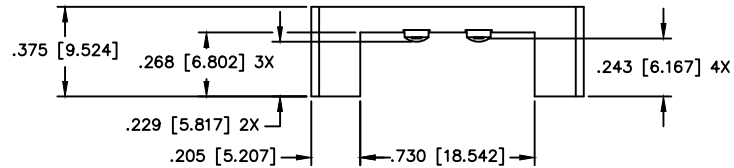

ELECTRICAL SPECIFICATIONS

FREQUENCY: DC - 3000 MHZ.

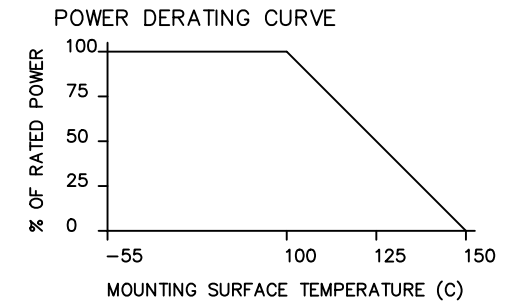

PART NO.	PER RESISTOR			
	VALUE	TOLERANCE	POWER	CAPACITANCE
IPP-RB403-100	100	+/- 5%	15W	0.75 pF
IPP-RB403-200	200	+/- 5%	15W	0.75 pF
IPP-RB403-250	250	+/- 5%	15W	0.75 pF
IPP-RB403-500	500	+/- 5%	15W	0.75 pF
IPP-RB403-1000	1000	+/- 5%	15W	0.75 pF

MATERIAL [2] [3]	DWN S.Cornell	DATE 5-11-15	Innovative Power® Products			
	ENG DG	DATE 5-15				
FINISH [4]	MANUF	DATE	TITLE DUAL FEEDBACK RES, FLANGED			
	CAGE CODE: 437R2					
TOLERANCE IN [MM]	.XX ±.02 [.50]	SHEET OF 1 1	SCALE 2:1	SIZE B	P/N IPP-RB403-XXX	REV. B
	.XXX ±.010 [.254]					