

UNAUTHORIZED USE OF THIS  
DRAWING IS STRICTLY PROHIBITED

DAR	REV	DESCRIPTION	APPVD	DATE
3545	E	SEE DAR	DG	3-12
5019	F	SEE DAR	DG	6-14
7189	G	SEE DAR	DG	6-18

ELECTRICAL SPECIFICATIONS

PART NO.	VALUE	INPUT POWER	FRERQUENCY	VSWR
IPP-TB201-50	50 OHMS ±5%	30 WATT	DC-6.0 GHz	<1.13:1 DC-3.0 GHz <1.20:1 DC-4.0 GHz <1.50:1 DC-6.0 GHz
IPP-TB201-100	100 OHMS ±5%	30 WATT	DC-4.0 GHz	2±0.2:1

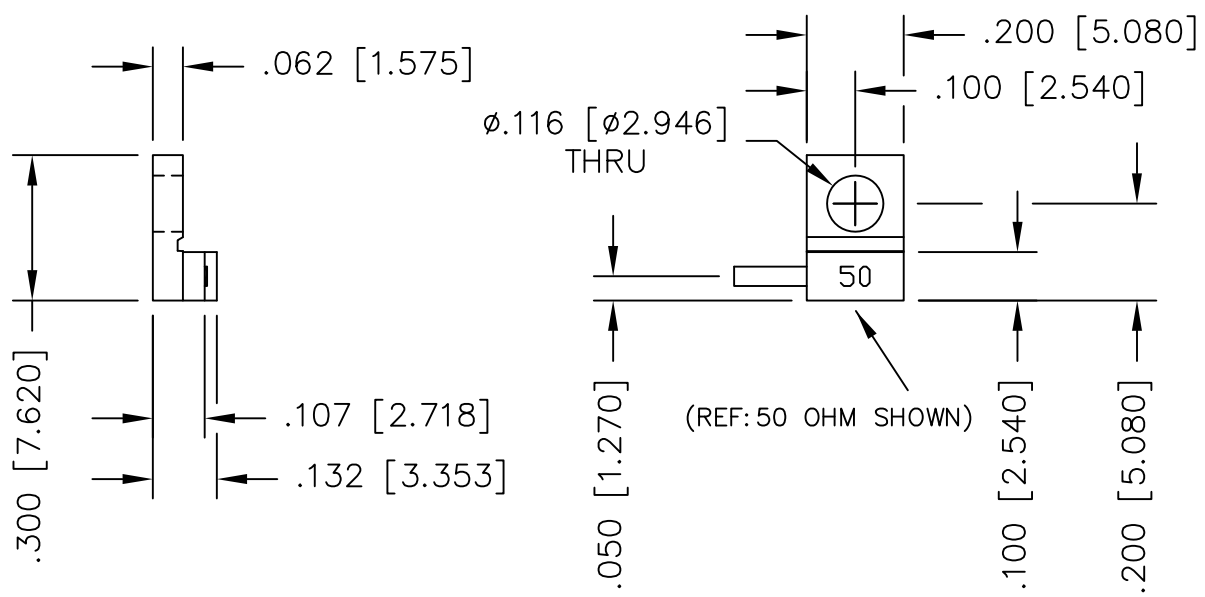

NOTES

- LEAD MATERIAL:  
99.99% PURE SILVER,  
.040 WIDE x .005 THICK
- LEAD LENGTH: .150 MIN.
- SUBSTRATE MATERIAL: BeO  
COVER MATERIAL: Al<sub>2</sub>O<sub>3</sub>
- FLANGE MATERIAL: COPPER  
PLATING: NICKEL
- DIMENSIONS: INCHES, [mm]
- RoHS COMPLIANT.

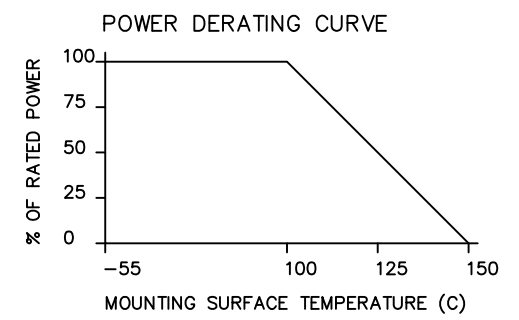

MATERIAL	<input type="checkbox"/> 3 <input type="checkbox"/> 4	DWN DG	DATE 1/06	
		ENG TJD	DATE 1/06	
FINISH	<input type="checkbox"/> 4	MANUF TP	DATE 1/06	
TOLERANCE	.XX ±.02 [.51] IN [MM] .XXX ±.010 [.254]	CAGE CODE: 437R2		
		SHEET 1 OF 1	SCALE 4:1	TITLE TERMINATION, 30 WATT, HALF FLANGE
SIZE	B	P/N	IPP-TB201-XXX	REV. G